

Cattywampus Log Cabin

Copyright © 2000 Caryl Bryer Fallert

one day workshop

Caryl Bryer Fallert • Bryerpatch Studio • caryl@bryerpatch.com • www.bryerpatch.com

- ☛ On a rectangle of paper, draw a series of lines from top to bottom. Draw each one at a different angle, so you have a series of quadrilaterals of different sizes and shapes.
- ☛ Decide on the arrangement of light and dark that you want for your project and mark all four sides of each quadrilateral with either L for light or D for dark. Adjoining edges should be the same shade. See traditional log cabin sets (below) for ideas.
- ☛ Select strips of fabric 1½"-2½" wide in light and dark values. Value is more important and the color.
- ☛ Select a fabric that is different than your strips for your center rectangles.
- ☛ Place a rectangle of your center fabric in the center of each of your quadrilaterals. This may be attached with a dot of glue stick, double stick tape or may be ironed on if you are

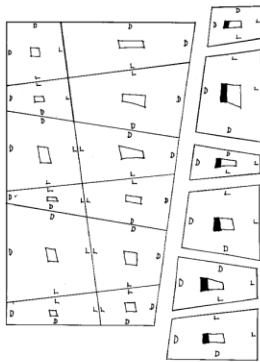
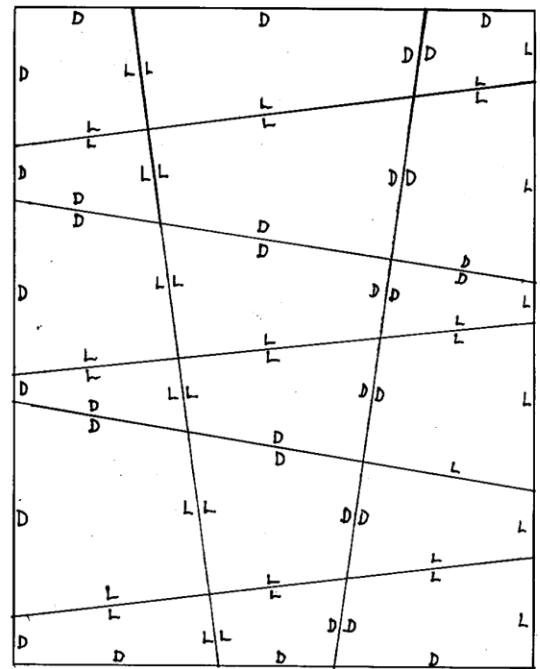
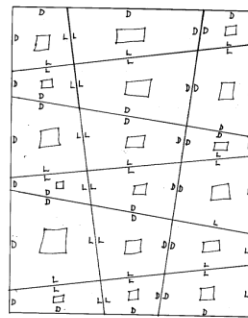
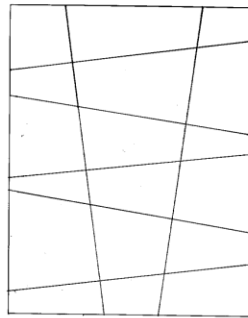

- ☛ Cut out one row of quadrilaterals and lay a strip of fabric on top of your center rectangle, along one edge. Strip should be dark if the edge of the paper is marked "D" and light if the edge of the paper is marked "L".
- ☛ Sew your strip to the edge of the center rectangle with a quarter inch seam. Stitching will perforate the paper. A very tight stitch length (25 per inch) is recommended to make removing the paper easier.
- ☛ Fold the strip toward the outside edge of the

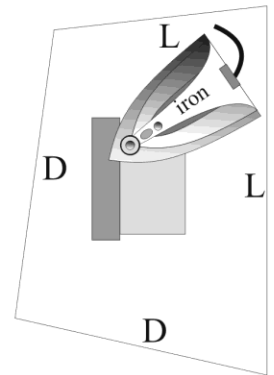
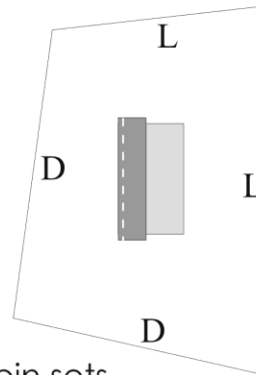

Traditional log cabin sets

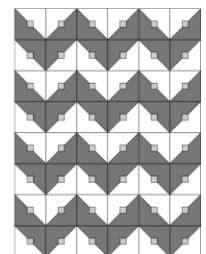
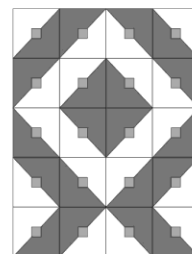
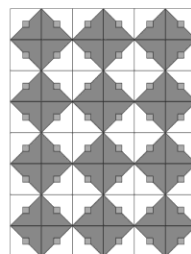
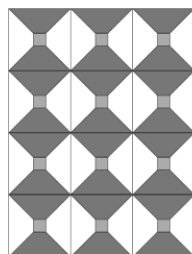
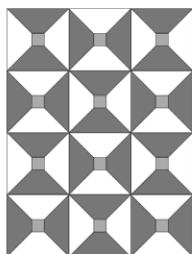
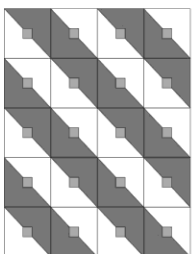

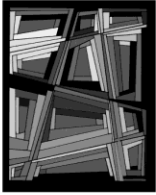

Cattywampus Log Cabin • page two

Copyright © 2000 Caryl Bryer Fallert

- Lay your next strip across the edge of strip one and the center rectangle, perpendicular to the last seam. Once again use the value (light or dark) indicated on the outer edge of the paper.
- Sew and press as you did strip one.
- Continue with additional strips, sewing each new strip over the last seam, as in traditional log cabin patchwork. Be careful each time to use the value indicated on the outside edge of the quadrilateral.
- As you get near the edge of your quadrilaterals, you may want to angle some of your strips as you sew them to make them parallel to the outside edge of the block.
- You will find that one edge of your block often gets covered before you are finished with the other edges of the block. Don't worry about this. Just add additional strips to the edges that are not yet covered.
- Be sure the last strip you sew extends at least one quarter inch beyond the edge of the paper.
- When your block is covered, turn it paper side up, and lay the quarter inch mark on your rotary ruler along the edge of the paper. Trim

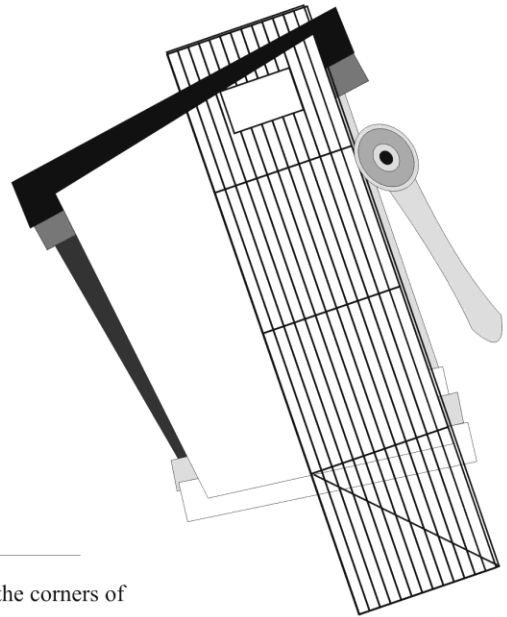
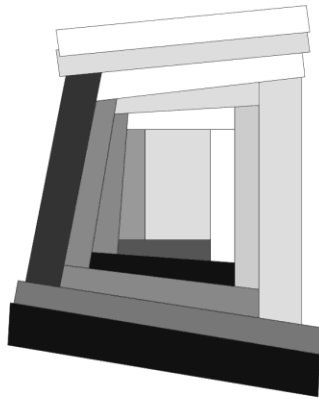
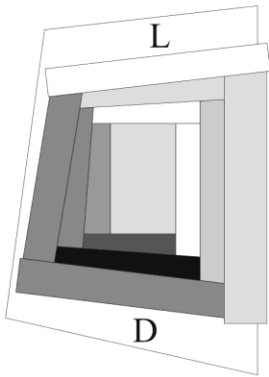
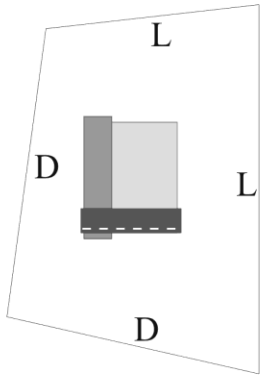
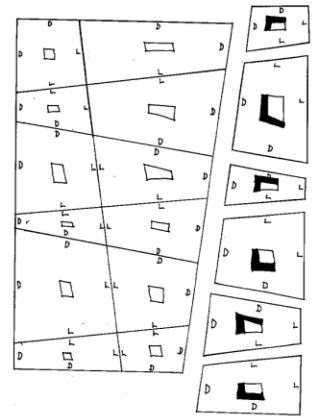

- Once all blocks in a row are complete, join the blocks. Pin at the corners of the paper and sew along the edge of the paper to join.
- Continue with additional rows until all blocks are joined.
- Join rows by pinning at seams and sewing along the edge of the paper.
- When all blocks are joined, remove paper

